

LITHIUM BATTERY ER26500M

优点及特征

工作电压平稳，在应用的寿命期内具有高而稳定的电压响应 低自放电率（在 +25°C 的条件下贮存，年自放电率低于 1%）
 气密的玻璃封口金属外盖
 非可燃性电解液
 卷绕式结构
 已通过 UL, CE, SGS 认证
 通过 ISO9001 质量管理体系认证

Key Characteristics

High and stable operating voltage
 Low self-discharge rate(less than 1% after 1 year storage at +25°C)
 Hermetic glass-to-metal sealing
 Non-flammable electrolyte
 Spiral type
 UL,CE,SGS recognized
 ISO9001 approved

性能数据

标称容量 6500mAh
 额定电压 3.6V
 最大连续工作电流 1500mA
 最大脉冲电流 2500mA
 电池重量 约 55g
 电池最大外形尺寸 Ø26.2*50.0mm
 工作温度 -60°C ~ +85°C

Electrical Characteristics

Nominal capacity 6500mAh
 Nominal voltage 3.6V
 Max.continuous current 1500mA
 Max.pulse current capability 2500mA
 Weight Approx.55g
 Dimension Ø26.2*50.0mm
 Operating temperature range -60°C ~+85°C

25°C 放电特性 Discharge Characteristics(25°C)

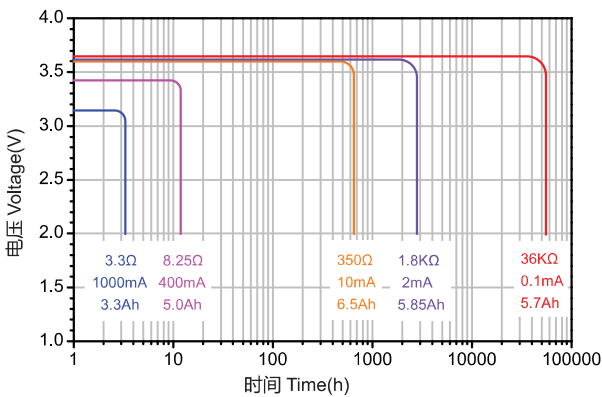

电压与温度关系 Voltage vs. Temperature

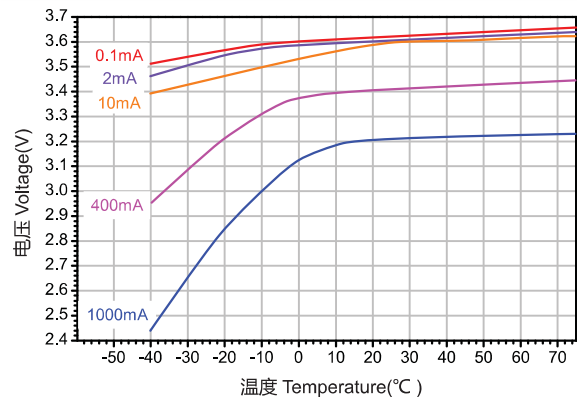

容量与电流关系 Capacity vs. Current

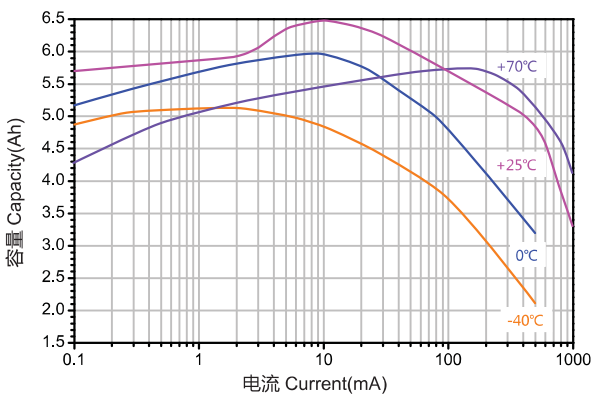

电池尺寸图 Battery Dimension

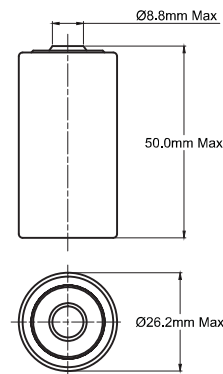

- + Available terminations:
 -/P axialpins
 -2PT/T radial pins
 -3PT/4PT polarized tabs

极端样式：
 -/P 轴向碰焊线
 -2PT/T 径向插件
 -3PT/4PT 多脚插件

- + Available terminations can be made as requested.
 特殊极端样式可按客户要求订做